

1		2		3		4		5		6	
Document No.		QR4-700-T-003		REV.		DESCRIPTION		REVISOR		DATE	
REV.		A/0		0				JUNMA		04.07.2017	
										APPROVED	
										David	

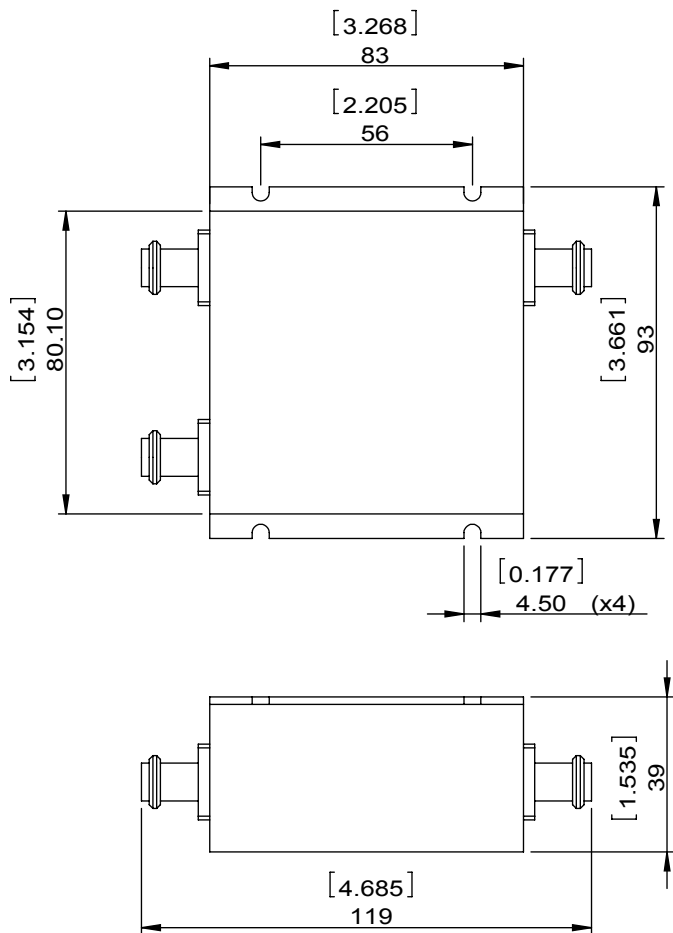

SPECIFICATIONS	
Part's Number	2CCH31-1
Frequency(GHz)	0.225~0.400
Direction	CW
Insertion Loss(dB) TYP/MAX	1.0/1.5
Insertion Loss Ripple	
Isolation(dB) TYP/MIN	17/15
Return Loss(dB) TYP/MIN	15.56/13.98
3rd IMD(dBc)MAX	
Power FWD/REV/PK(Watt)	400/400/400
Operating Temperature(°C)	25/-10~+50
Storage Temperature(°C)	
2nd/3rd Harmonic(dBc)	
Termination/Attenuator(Watt/dB)	400
Tab(W×LG×THK)(mm[Inch])	
Additional Notes	GWB

		DORADO Millimeter Wave			
MATERIAL:		DWG NO: 2CCH31-1			
SURFACE TREATMENT:		DWG BY: JUNMA		04.07.2017	
DESCRIPTION: BROADBAND CIRCULATOR		CHK'D BY:		SCALE: 1:1	
APPV'D BY:		Unit: mm[inch]		Tolerance: Liner: ±0.25 Anguar: ±0.5°	
The First:				A4	



This document is the property of DORADO Millimeter Wave. It cannot be copied, duplicated, used for manufacturing purposes or communicated to third party as a whole or partly, without the written consent of DORADO Millimeter Wave.