

1		2		3		4		5		6	
Document No.		QR4-700-T-003		REV.		DESCRIPTION		REVISOR		DATE	
REV.		A/0		0				JUNMA		04.05.2017	
								APPROVED		David	

SPECIFICATIONS	
Part's Number	3CCM11-1
Frequency(GHz)	1000~1100
Direction	CW
Insertion Loss(dB) TYP/MAX	0.2/0.8
Insertion Loss Ripple	
Isolation(dB) TYP/MIN	20/17
Return Loss(dB) TYP/MIN	19.08/15.56
3rd IMD(dBc)MAX	
Power FWD/REV/PK(Watt)	200/200/200
Operating Temperature(°C)	0~+50
Storage Temperature(°C)	
2nd/3rd Harmonic(dBc)	
Termination/Attenuator(Watt/dB)	200
Tab(W×LG×THK)(mm[Inch])	
Additional Notes	GWB

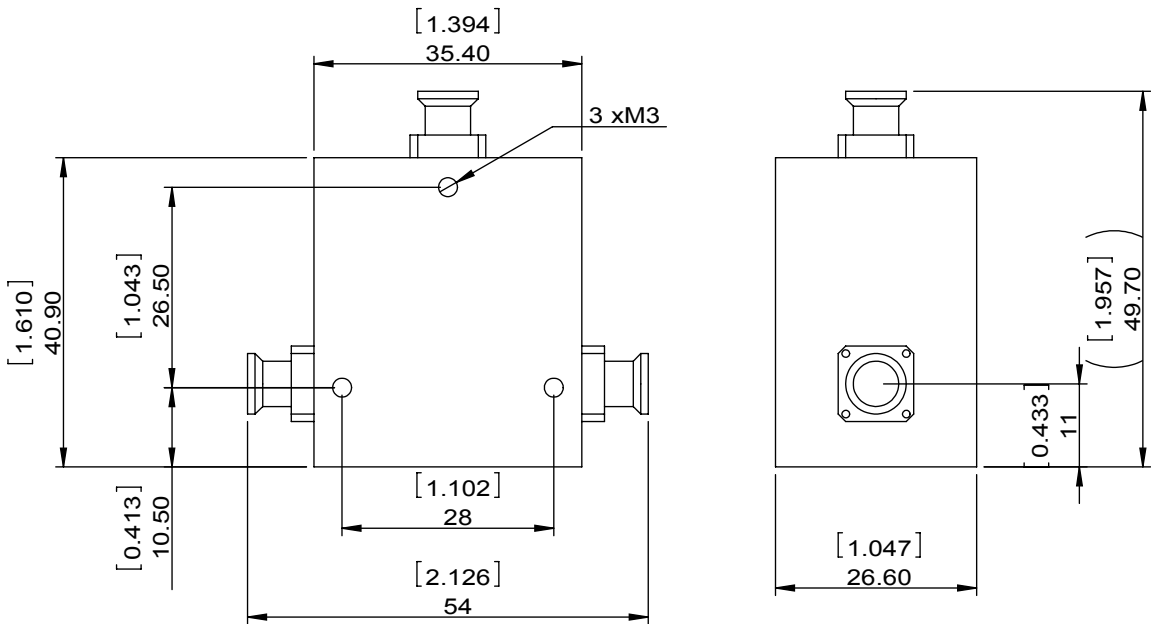

DORADO INTERNATIONAL DORADO Millimeter Wave

MATERIAL:	DWG NO: 3CCM11-1			
SURFACE TREATMENT:	DWG BY:	JUNMA	04.05.2017	SCALE
	CHK'D BY:			
DESCRIPTION: BROADBAND CIRCULATOR	APPV'D BY:			1:1
	Unit:	Tolerance:	The First:	A4
	mm[inch]	Liner: ±0.25 Anguar: ±0.5°		



This document is the property of DORADO Millimeter Wave. It cannot be copied, duplicated, used for manufacturing purposes or communicated to third party as a whole or partly, without the written consent of DORADO Millimeter Wave.