

1		2		3		4		5		6	
Document No.		QR4-700-T-003		REV.		DESCRIPTION		REVISOR		DATE	
REV.		A/0		0				JUNMA		05.11.2017	
										APPROVED	
										David	

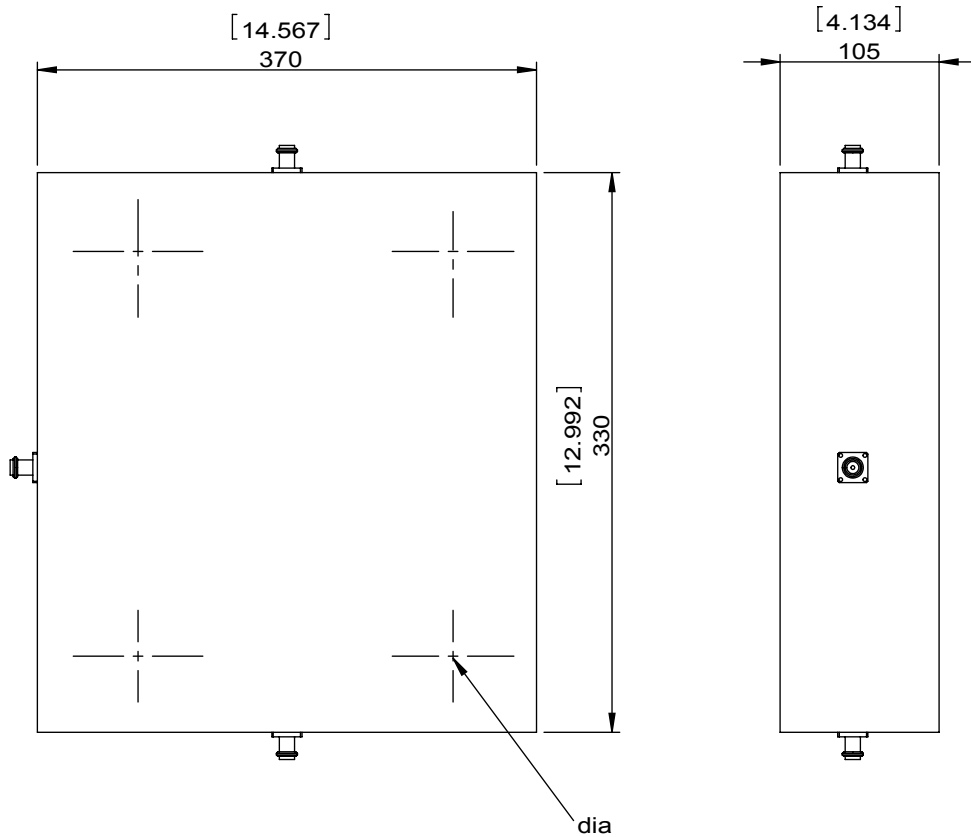

SPECIFICATIONS	
Part's Number	1CCH85-1
Frequency(GHz)	0.060~0.100
Direction	CW
Insertion Loss(dB)MAX	0.5
Insertion Loss Ripple	
Isolation(dB)MIN	18
Return Loss(dB)MIN	17.69
3rd IMD(dBc)MAX	
Power FWD/REV/PK(Watt)	4000/4000/6000
Operating Temperature(°C)	+5~+45
Storage Temperature(°C)	
2nd/3rd Harmonic(dBc)	
Termination/Attenuator(Watt/dB)	4000
Tab(W×LG×THK)(mm[Inch])	
Additional Notes	GWB

DORADO Millimeter Wave				
<b>MATERIAL:</b>		<b>DWG NO:</b>		
		1CCH85-1		
<b>SURFACE TREATMENT:</b>		DWG BY:	JUNMA	05.11.2017
		CHK'D BY:		SCALE
<b>DESCRIPTION:</b>		APPV'D BY:		1:3
<b>HIGH POWER CIRCULATOR</b>		Unit:	Tolerance:	The First:
		mm[inch]	Liner: ±0.25	
			Anguar: ±0.5°	A4



This document is the property of DORADO Millimeter Wave. It cannot be copied, duplicated, used for manufacturing purposes or communicated to third party as a whole or partly, without the written consent of DORADO Millimeter Wave.