

|              |               |      |     |      |             |         |            |          |  |   |  |
|--------------|---------------|------|-----|------|-------------|---------|------------|----------|--|---|--|
| 1            |               | 2    |     | 3    |             | 4       |            | 5        |  | 6 |  |
| Document No. | QR4-700-T-003 | REV. | A/0 | REV. | DESCRIPTION | REVISOR | DATE       | APPROVED |  |   |  |
|              |               | 0    |     |      |             | JUNMA   | 05.11.2017 | David    |  |   |  |

| SPECIFICATIONS                  |               |
|---------------------------------|---------------|
| Part's Number                   | 2CCH16-1      |
| Frequency(GHz)                  | 0.15~0.17     |
| Direction                       | CW            |
| Insertion Loss(dB)MAX           | 0.5           |
| Insertion Loss Ripple           |               |
| Isolation(dB)MIN                | 20            |
| Return Loss(dB)MIN              | 19.08         |
| 3rd IMD(dBc)MAX                 |               |
| Power FWD/REV/PK(Watt)          | 600/600/12000 |
| Operating Temperature(°C)       | 0~+50         |
| Storage Temperature(°C)         |               |
| 2nd/3rd Harmonic(dBc)           |               |
| Termination/Attenuator(Watt/dB) | 600           |
| Tab(W×LG×THK)(mm[Inch])         |               |
| Additional Notes                | GWB           |

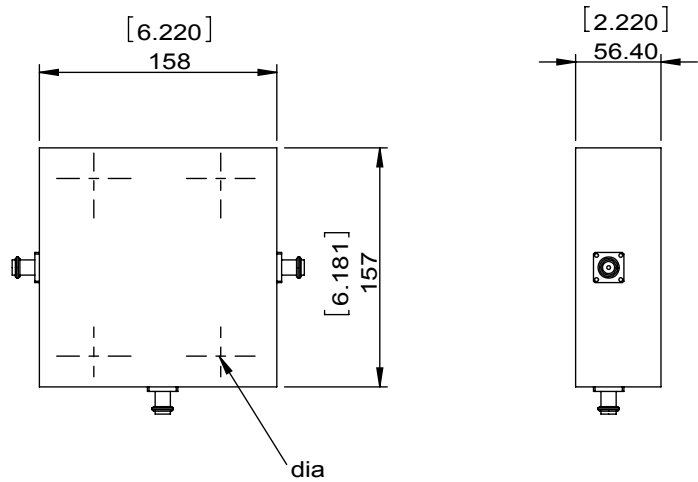

**DORADO INTERNATIONAL** **DORADO Millimeter Wave**

|  |                            |                               |            |       |
|--|----------------------------|-------------------------------|------------|-------|
| <b>MATERIAL:</b>                             | <b>DWG NO:</b><br>2CCH16-1 |                               |            |       |
| <b>SURFACE TREATMENT:</b>                    | DWG BY:                    | JUNMA                         | 05.11.2017 | SCALE |
|  | CHK'D BY:                  |                               |            | 1:3   |
| <b>DESCRIPTION:</b><br>HIGH POWER CIRCULATOR | APP'V'D BY:                |                               |            |       |
|  | Unit:                      | Tolerance:                    | The First: |       |
|  | mm[inch]                   | Liner: ±0.25<br>Anguar: ±0.5° |            |       |



This document is the property of DORADO Millimeter Wave. It cannot be copied, duplicated, used for manufacturing purposes or communicated to third party as a whole or partly, without the written consent of DORADO Millimeter Wave.