

1		2		3		4		5		6		
Document No. QR4-700-T-003								REV.	DESCRIPTION	REVISOR	DATE	APPROVED
REV. A/0								0		JUNMA	04.05.2017	David

SPECIFICATIONS	
Part's Number	3CCM11-3
Frequency(GHz)	0.960~1.215
Direction	CW
Insertion Loss(dB) TYP/MAX	0.5/0.5
Insertion Loss Ripple	
Isolation(dB) TYP/MIN	20/18
Return Loss(dB) TYP/MIN	19.08/17.69
3rd IMD(dBc)MAX	
Power FWD/REV/PK(Watt)	70/70/10000
Operating Temperature(°C)	0~+50
Storage Temperature(°C)	
2nd/3rd Harmonic(dBc)	
Termination/Attenuator(Watt/dB)	70
Tab(W×LG×THK)(mm[Inch])	
Additional Notes	GWB

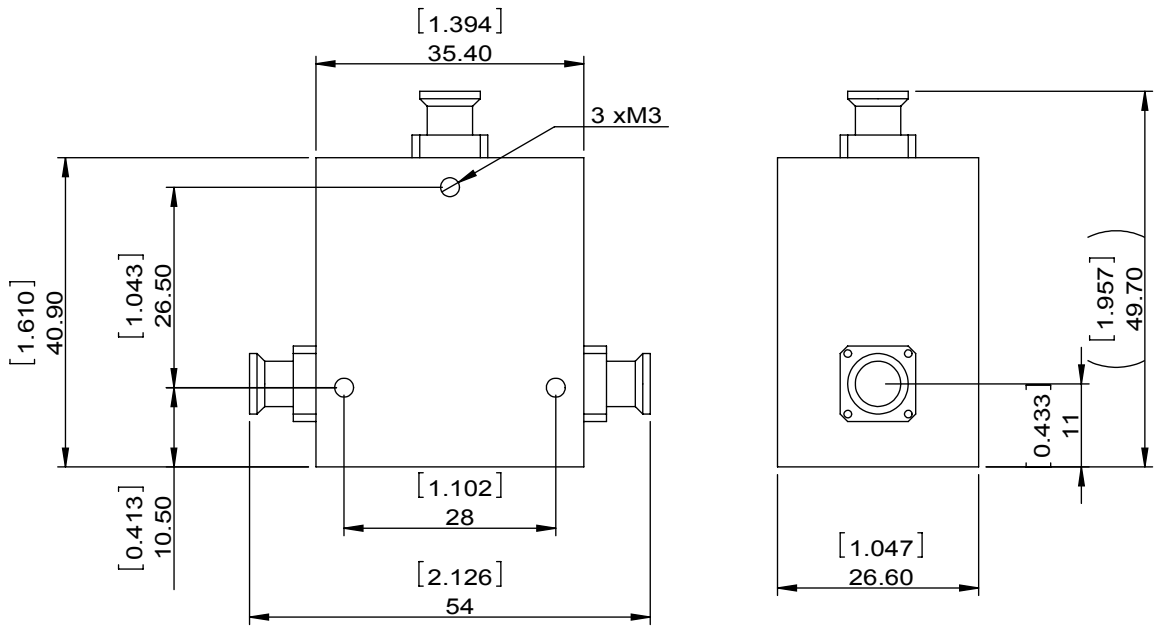

DORADO INTERNATIONAL DORADO Millimeter Wave

MATERIAL:	DWG NO: 3CCM11-3			
SURFACE TREATMENT:	DWG BY:	JUNMA	04.05.2017	SCALE
	CHK'D BY:			
DESCRIPTION: BROADBAND CIRCULATOR	APPV'D BY:			1:1
	Unit:	Tolerance:	The First:	A4
	mm[inch]	Liner: ±0.25 Anguar: ±0.5°		



This document is the property of DORADO Millimeter Wave. It cannot be copied, duplicated, used for manufacturing purposes or communicated to third party as a whole or partly, without the written consent of DORADO Millimeter Wave.