

| | | | | | | | | | | | |
|--------------|--|---------------|--|------|--|---|--|-------------|--|------------|--|
| 1 | | 2 | | 3 | | 4 | | 5 | | 6 | |
| Document No. | | QR4-700-T-003 | | REV. | | 0 | | DESCRIPTION | | APPROVED | |
| REV. | | A/0 | | | | | | REVISOR | | DATE | |
| | | | | | | | | JUNMA | | 04.05.2017 | |
| | | | | | | | | | | David | |

| SPECIFICATIONS | |
|---------------------------------|-------------|
| Part's Number | 3CCM12-2 |
| Frequency(GHz) | 0.94~1.41 |
| Direction | CW |
| Insertion Loss(dB) TYP/MAX | 0.8/1.0 |
| Insertion Loss Ripple | |
| Isolation(dB) TYP/MIN | 17/16 |
| Return Loss(dB) TYP/MIN | 15.56/13.98 |
| 3rd IMD(dBc)MAX | |
| Power FWD/REV/PK(Watt) | 200/200/200 |
| Operating Temperature(°C) | 25/-30~+70 |
| Storage Temperature(°C) | |
| 2nd/3rd Harmonic(dBc) | |
| Termination/Attenuator(Watt/dB) | 200 |
| Tab(W×LG×THK)(mm[Inch]) | |
| Additional Notes | GWB |

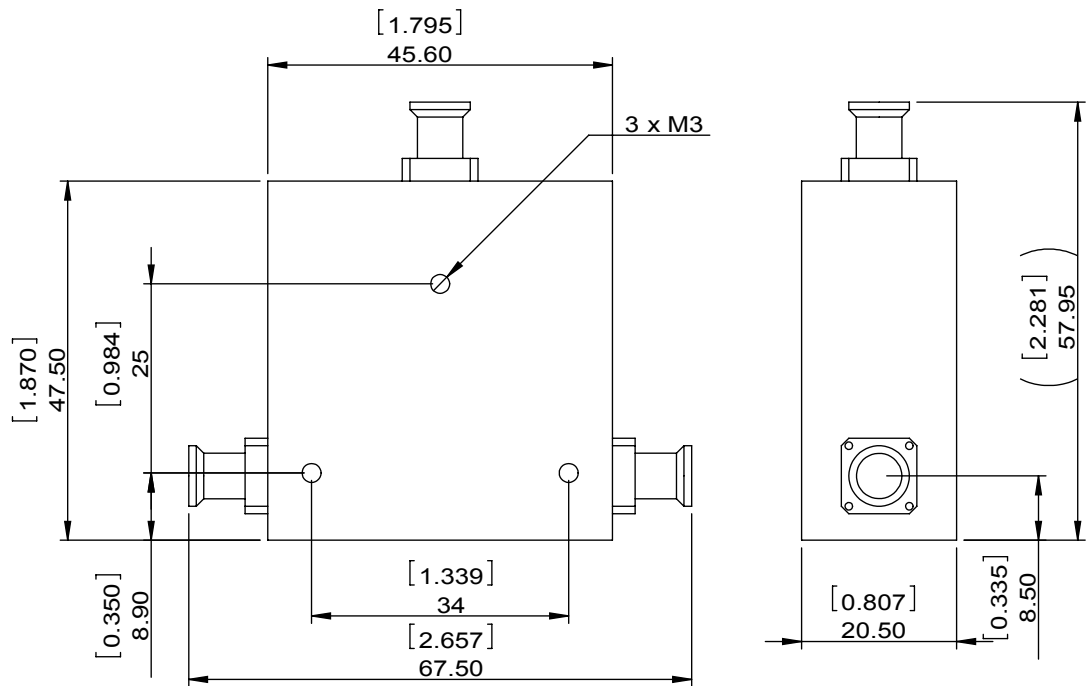

This document is the property of DORADO Millimeter Wave. It cannot be copied, duplicated, used for manufacturing purposes or communicated to third party as a whole or partly, without the written consent of DORADO Millimeter Wave.

DORADO INTERNATIONAL **DORADO Millimeter Wave**

| | | | | |
|--|----------------------------|---|------------|-------|
| MATERIAL: | DWG NO: 3CCM12-2 | | | |
| SURFACE TREATMENT: | DWG BY: | JUNMA | 04.05.2017 | SCALE |
| DESCRIPTION: BROADBAND CIRCULATOR | CHK'D BY: | | | 1:1 |
| | APP'V'D BY: | | | A4 |
| | Unit: mm[inch] | Tolerance: Liner: ±0.25 Anguar: ±0.5° | The First: | |