

1		2		3		4		5		6	
Document No.	QR4-700-T-003	REV.	A/0	REV.	DESCRIPTION	REVISOR	DATE	APPROVED			
		0		JUNMA	04.05.2017	David					

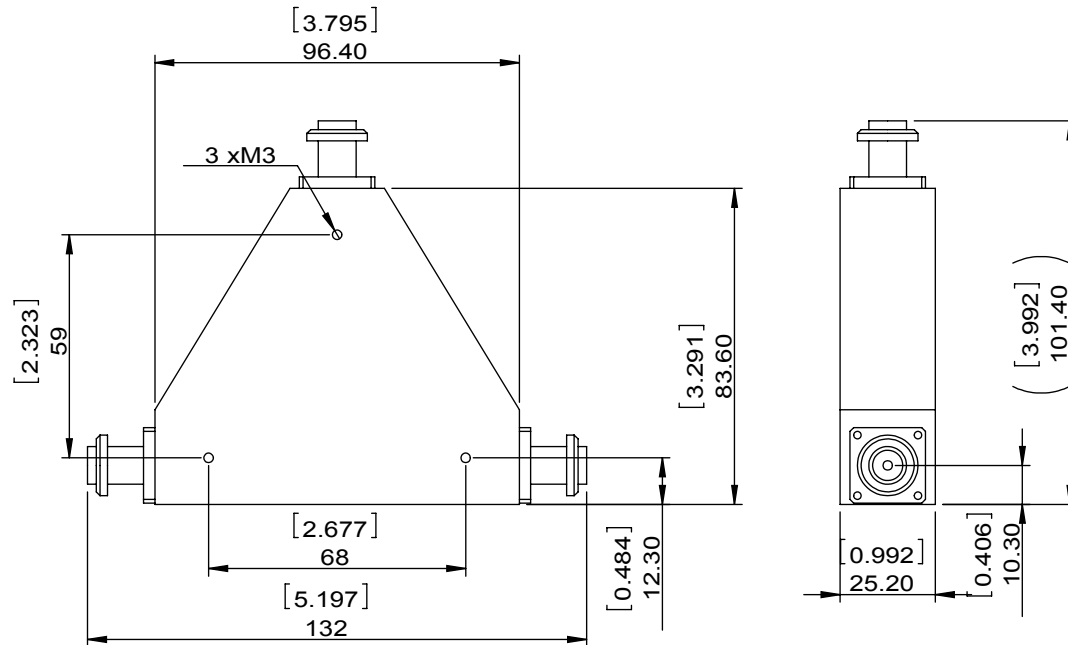

SPECIFICATIONS	
Part's Number	3CCM15-1
Frequency(GHz)	1.00~2.00
Direction	CW
Insertion Loss(dB) TYP/MAX	0.5/0.8
Insertion Loss Ripple	
Isolation(dB) TYP/MIN	17/14
Return Loss(dB) TYP/MIN	16.54/12.74
3rd IMD(dBc) TYP/MAX	
Power FWD/REV/PK(Watt)	250/250/250
Operating Temperature(°C)	25/-60~+55
Storage Temperature(°C)	
2nd/3rd Harmonic(dBc)	
Termination/Attenuator(Watt/dB)	250
Tab(W×LG×THK)(mm[Inch])	
Additional Notes	GWB

<b>DORADO Millimeter Wave</b>	
<b>MATERIAL:</b>	<b>DWG NO:</b> 3CCM15-1
<b>SURFACE TREATMENT:</b>	DWG BY: JUNMA CHK'D BY: APPV'D BY:
<b>DESCRIPTION:</b> <b>BROADBAND CIRCULATOR</b>	04.05.2017 SCALE: 1:2
Unit: mm[inch]	Tolerance: Liner: ±0.25 Anguar: ±0.5°
	The First:
	A4



This document is the property of DORADO Millimeter Wave. It cannot be copied, duplicated, used for manufacturing purposes or communicated to third party as a whole or partly, without the written consent of DORADO Millimeter Wave.