

1		2		3		4		5		6	
Document No.	QR4-700-T-003	REV.	A/0	REV.	DESCRIPTION	REVISOR	DATE	APPROVED			
		0		JUNMA	04.05.2017	David					

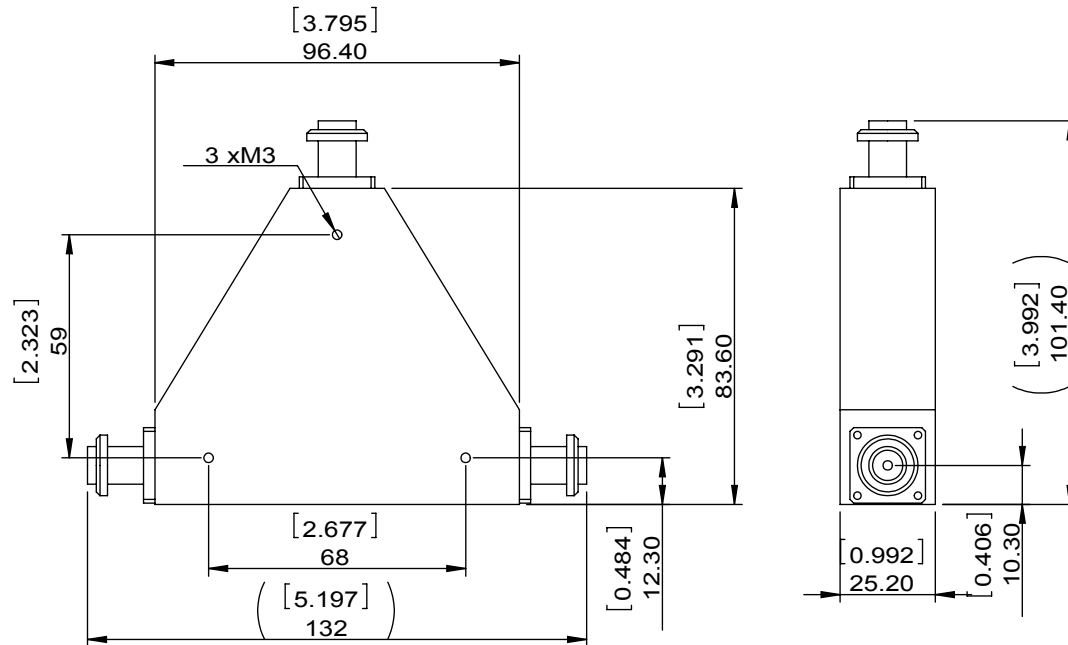

SPECIFICATIONS	
Part's Number	3CCM20-4
Frequency(GHz)	1.00~3.00
Direction	CW
Insertion Loss(dB)MAX	1.1/1.3
Insertion Loss Ripple	
Isolation(dB)MIN	14/12
Return Loss(dB)MIN	13.98/12.01
3rd IMD(dBc)MAX	
Power FWD/REV/PK(Watt)	250/250/250
Operating Temperature(°C)	25/+1~+70
Storage Temperature(°C)	
2nd/3rd Harmonic(dBc)	
Termination/Attenuator(Watt/dB)	250
Tab(W×LG×THK)(mm[Inch])	
Additional Notes	GWB

DORADO Millimeter Wave	
MATERIAL:	DWG NO: 3CCM20-4
SURFACE TREATMENT:	DWG BY: JUNMA CHK'D BY: APPV'D BY:
DESCRIPTION: BROADBAND CIRCULATOR	04.05.2017 SCALE: 1:2
Unit: mm[inch]	Tolerance: Liner: ±0.25 Anguar: ±0.5°
	The First:
	A4



This document is the property of DORADO Millimeter Wave. It cannot be copied, duplicated, used for manufacturing purposes or communicated to third party as a whole or partly, without the written consent of DORADO Millimeter Wave.