

1		2		3		4		5		6	
Document No.		QR4-700-T-003		REV.		DESCRIPTION		REVISOR		DATE	
REV.		A/0		0				LH.Mao		03.27.2017	
										APPROVED	
										David	

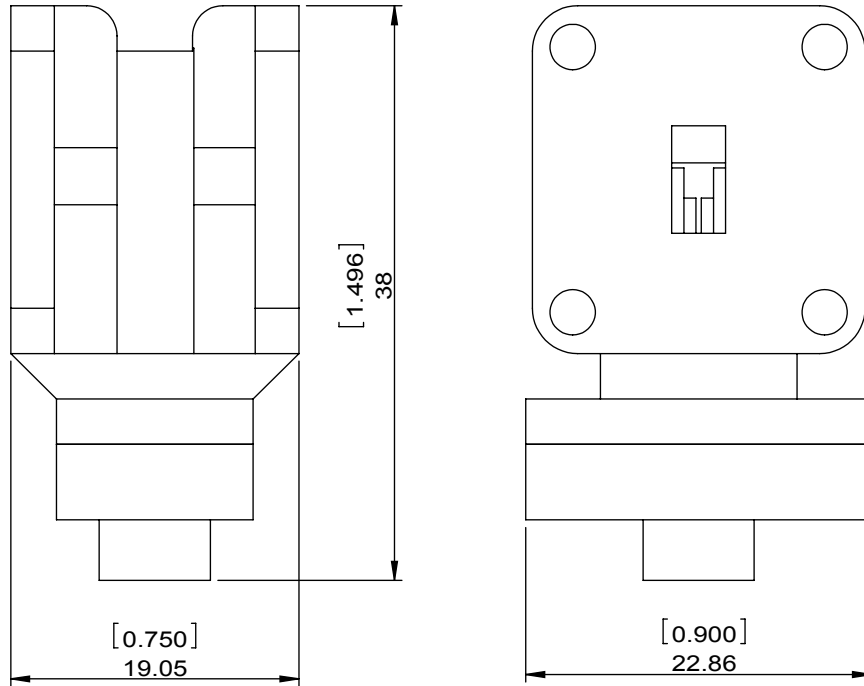

SPECIFICATIONS	
Part's Number	4IWC30-1
Frequency(GHz)	28.0~33.0
Direction	CW
Insertion Loss(dB)MAX	0.3
Insertion Loss Ripple	
Isolation(dB)MIN	20
Return Loss(dB)MIN	20.83
3rd IMD(dBc)MAX	
Power FWD/REV/PK(Watt)	
Operating Temperature(°C)	4~77K
Storage Temperature(°C)	
2nd/3rd Harmonic(dBc)	
Termination/Attenuator(Watt/dB)	
Tab(W×LG×THK)(mm[Inch])	
Additional Notes	GWB

<b>DORADO Millimeter Wave</b>	
<b>MATERIAL:</b>	<b>DWG NO:</b> 4IWC30-1
<b>SURFACE TREATMENT:</b>	DWG BY: LH.Mao 03.27.2017 SCALE
<b>DESCRIPTION:</b> Waveguide Isolator	CHK'D BY: APPV'D BY: Unit: mm[inch] Tolerance: Liner: ±0.25 Anguar: ±0.5° The First:
	2:1 A4



This document is the property of DORADO Millimeter Wave. It cannot be copied, duplicated, used for manufacturing purposes or communicated to third party as a whole or partly, without the written consent of DORADO Millimeter Wave.